

C:\Documents and Settings\283947\Desktop\BPEM13\Standard\10062010\BPEM14.dwg Oct 06, 2010 - 10:23am

NOTICE TO CONTRACTORS
GENERAL NOTES

- 1. ALL WORK SHALL CONFORM TO THE LATEST EDITION OF PUBLIC WORKS OF THE CITY OF LOS ANGELES ADOPTED EDITION AND SUPPLEMENTS TO THE "HANDBOOK STANDARD SPECIFICATIONS FOR PUBLIC WORKS CONSTRUCTION" AS MODIFIED BY THE CORRESPONDING ISSUE OF THE BROWN BOOK, THE LATEST EDITION OF THE BUREAU OF STREET LIGHTING "SPECIAL SPECIFICATIONS", AND THE SPECIAL PROVISIONS.
- 2. ELECTROLIER SHALL BE INSTALLED WITH CENTERLINE 24" BEHIND THE CURB FACE, AND WITH LUMINAIRE ARM ORIENTED OVER THE STREET AND PERPENDICULAR TO ITS CENTER LINE, EXCEPT AS OTHERWISE SPECIFIED HEREON.
- 3. ELECTROLIER SPECIFIED TO BE LOCATED INSIDE OF THE CURB RETURN SHALL BE INSTALLED WITH THE CENTER OF THE ELECTROLIER 30 INCHES BEHIND THE CURB FACE MEASURED RADIALLY, AND WITH THE LUMINAIRE ARM ORIENTED OVER THE STREET AND PERPENDICULAR TO THE STREET CENTERLINE.
- 4. THE CONTRACTOR SHALL BE RESPONSIBLE FOR THE BASE DOOR IS PERPENDICULAR TO THE CURB AND LOCATED ON THE SIDE OF THE ELECTROLIER AWAY FROM ONCOMING TRAFFIC.
- 5. ALL EXISTING ELECTROLIER SPECIFIED TO BE REMOVED OR MODIFIED ON THIS PLAN SHALL BE MAINTAINED IN SERVICE UNTIL THE NEW ELECTROLIER LIGHTING SYSTEM IS PLACED IN SERVICE, UNLESS OTHERWISE SPECIFIED HEREON. ALL OTHER ELECTROLIER ON CIRCUITS AFFECTED BY THIS PLAN SHALL BE MAINTAINED IN SERVICE. CONTRACTOR MAY PROVIDE ALTERNATE LIGHTING IN LIEU OF MAINTAINING EXISTING ELECTROLIER LIGHTS IN SERVICE PROVIDED THAT SUCH ARRANGEMENTS ARE APPROVED BY THE ENGINEER.
- 6. ALL EQUIPMENT REQUIRED HEREON FOR FURNISHING ELECTRICAL SERVICE FOR EACH CIRCUIT SHALL BE INSTALLED AND INSPECTED PRIOR TO ANY OTHER CONSTRUCTION ON THAT CIRCUIT UNLESS OTHERWISE APPROVED BY THE ENGINEER.
- 7. THE CONTRACTOR SHALL GIVE WRITTEN NOTICE, 72 HOURS IN ADVANCE OF THE REMOVAL OF AN ELECTROLIER, TO ANY PUBLIC AGENCY MAINTAINING EQUIPMENT SUPPORTED BY THAT ELECTROLIER.
- 8. FOUNDATIONS AND PULLBOXES NOT REMAINING IN SERVICE SHALL BE REMOVED. THE RESULTING EXCAVATION SHALL BE FILLED WITH MATERIAL SIMILAR TO ADJACENT MATERIAL AND SATISFACTORILY COMPACTED WITH A MECHANICAL COMPACTOR IN LAYERS NOT EXCEEDING 12 INCHES. THE SURFACE SHALL BE FINISHED TO MATCH THE ADJACENT SURFACE.
- 9. THE CONTRACTOR SHALL REQUEST A BURN TEST BY NOTIFYING THE BUREAU OF CONTRACT ADMINISTRATION PROJECT INSPECTOR A MINIMUM OF 7 CALENDAR DAYS IN ADVANCE OF THE DATE ON WHICH A BURN TEST IS DESIRED.
- 10. CONTRACTOR SHALL GIVE THREE WORKING DAYS NOTICE (PHONE 323-913-4743) PRIOR TO DELIVERY OF ANY EQUIPMENT SPECIFIED TO BE DELIVERED TO THE BUREAU OF STREET LIGHTING YARD AT 4550 SANTA MONICA BLVD.. SUCH DELIVERIES SHALL BE BETWEEN 8:30 AM AND 3:00 PM AND SHALL INCLUDE ALL HANDLING AND LOADING FROM THE TRUCK BY THE CONTRACTOR. CONTRACTOR MUST SUPPLY A COPY OF THE STREET LIGHTING SHEETS WITH THE DELIVERY OF MATERIAL.
- 11. PULLBOXES LOCATED ADJACENT TO DRIVEWAYS AND ALLEYS SHALL BE INSTALLED AT A MINIMUM DISTANCE OF FIVE FEET FROM THE TOP OF THE "X" OF CASE 1 OR CASE 2 DRIVEWAY OR AT A MINIMUM DISTANCE OF TWO FEET FROM THE B.C. OF A CASE 3 OR CASE 4 DRIVEWAY OR FIVE FEET FROM TRAVELLED WAY OF THE ALLEY.
- 12. PULLBOXES INSTALLED AT INTERSECTIONS OF LOCAL STREET SHALL BE INSTALLED NO CLOSER TO THE INTERSECTIONS THAN THE B.C.R. OF AN ASSUMED FUTURE 25' RADIUS CURB RETURN UNLESS OTHERWISE APPROVED BY THE ENGINEER. PULLBOXES INSTALLED AT INTERSECTIONS WHICH INVOLVE ONE OR MORE MAJOR OR SECONDARY STREETS SHALL BE INSTALLED NO CLOSER TO INTERSECTIONS THAN THE B.C.R. OF AN ASSUMED FUTURE 35' RADIUS CURB RETURN UNLESS OTHERWISE APPROVED BY THE ENGINEER.
- 13. CONDUIT SHALL BE INSTALLED AROUND ALL EXISTING AND/OR PROPOSED CATCH BASINS PER BUREAU OF STREET LIGHTING STANDARD DRAWING NO. L-304-0 UNLESS OTHERWISE SPECIFIED.
- 14. ALL SCREWS PROVIDED FOR ELECTROLIER STANDARD BASE DOORS AND BASE COVERS SHALL BE CADMIUM PLATED STEEL, 1/4"-20NC MACHINE SCREWS, WITH PHILLIPS RECESSED ROUND HEADS.
- 15. WARNING: SAFETY CLEARANCE SHALL BE OBTAINED DAILY FROM THE AFFECTED UTILITY COMPANY BEFORE DOING ANY WORK IN CLOSE PROXIMITY TO ANY OVERHEAD ELECTRIC LINE. SEE SECTIONS 16430 AND 2100 OF SPECIAL SPECIFICATIONS.
- 16. UNLESS OTHERWISE SPECIFIED HEREON, LUMINAIRES SHALL PROVIDE A MEDIUM, CUTOFF, TYPE III, LIGHTING DISTRIBUTION PATTERN CONFORMING TO I.E.S. DESIGNATION.
- 17. CONTRACTOR SHALL BE RESPONSIBLE FOR PRESERVING THE CONDITION OF ALL EXISTING EQUIPMENT TO BE REUSED, MODIFIED OR RETURNED TO THE BUREAU OF STREET LIGHTING YARD.
- 18. EQUIPMENT INDICATED "DISPOSE" SHALL BECOME THE PROPERTY OF THE CONTRACTOR AND BE DISPOSED OF BY THE CONTRACTOR.
- 19. STREET LIGHTING CONDUIT SHALL BE INSTALLED BY JACKING OR DRILLING METHODS. INSTALLATION OF CONDUIT BY OPEN TRENCHING IS NOT PERMITTED UNLESS APPROVED BY THE DIRECTOR, BUREAU OF STREET LIGHTING.
- 20. CONTRACTOR SHALL REPAIR AT HIS COST, THE DAMAGE CAUSED TO EXISTING SPRINKLER SYSTEMS DURING THE CONSTRUCTION OF THIS PROJECT. REPAIRS SHALL BE MADE WITHIN 5 WORKING DAYS AFTER DAMAGE OCCURS.
- 21. ALL ELECTROLIER SPECIFIED HEREON SHALL INCLUDE A TYPE 2 PULLBOX, TO BE SUPPLIED AND INSTALLED, UNLESS OTHERWISE SPECIFIED.
- 22. CONTRACTOR SHALL BE RESPONSIBLE TO ALL EXISTING ELECTROLIER SPECIFIED TO BE RELOCATED AND MODIFIED ON THIS PLAN. PRIOR TO REINSTALLATION, CONTRACTOR SHALL REPAIR OR REPLACE ALL EXISTING STREET LIGHTING FACILITIES FOUND TO BE DAMAGED PRIOR TO START OF OR DURING THE CONSTRUCTION OF THIS PROJECT AT NO COST TO THE CITY.

SUPPLEMENTAL NOTES

- 1. CONTRACTOR SHALL LOCATE & PROTECT SUBSTRUCTURE(S) SHOWN HEREON, & SHALL PROVIDE FOR A MINIMUM 12" HORIZONTAL CLEARANCE BETWEEN FOUNDATION & SUBSTRUCTURES. IN THE EVENT A 12" CLEARANCE CANNOT BE ACHIEVED, THE CONTRACTOR SHALL MAKE ARRANGEMENTS FOR RELOCATION OF SUBSTRUCTURES AT NO COST TO THE CITY.
- 2. IN THE EVENT OF OVERHEAD LINES CONFLICT WITH ELECTROLIER THE CONTRACTOR SHALL MAKE NECESSARY ARRANGEMENTS WITH THE DEPT. OF WATER AND POWER TO RAISE THEIR OVERHEAD FACILITIES IN ORDER TO PROVIDE FOR THE FOLLOWING CLEARANCES WITH EXISTING AND/OR PROPOSED ELECTROLIER.
LOW VOLTAGE: MINIMUM 3' CLEARANCE BETWEEN OVERHEAD LINES AND ELECTROLIER
HIGH VOLTAGE: MINIMUM 6' CLEARANCE BETWEEN OVERHEAD LINES AND ELECTROLIER
- 3. STREET TREES SHALL NOT BE PLANTED CLOSER THAN 20" FROM EXISTING OR PROPOSED ELECTROLIER, UNLESS OTHERWISE INDICATED.
- 4. IN THE EVENT OF OVERHEAD COMMUNICATION LINE CONFLICT WITH ELECTROLIER, CONTRACTOR SHALL MAKE NECESSARY ARRANGEMENTS TO PROVIDE A MINIMUM 12" CLEARANCE.
- 5. PROPOSED ELECTROLIER FOUNDATIONS AND PULLBOXES SHALL BE INSTALLED OUTSIDE OF ACCESS RAMP AREAS. EXISTING FOUNDATIONS AND PULLBOXES SHALL BE RECONSTRUCTED TO CLEAR ACCESS RAMPS BY A MINIMUM OF 12" EXISTING CONDUIT SHALL BE LOWERED AS NECESSARY PER SEC. 307-2.5 OF THE STANDARD SPECIFICATIONS FOR PUBLIC WORKS CONSTRUCTION.
- 6. CONDUIT THAT IS TO BE ABANDONED SHALL HAVE WIRES REMOVED. THE CONDUIT SHALL BE REMOVED TO A DEPTH OF AT LEAST 12" BELOW THE SURFACE AND HAVE BOTH ENDS CRIMPED.
- 7. NOTWITHSTANDING SECTION 16380.2 OF THE SPECIAL SPECIFICATIONS FOR THE CONSTRUCTION STREET LIGHTING SYSTEMS MAGNETIC REGULATING BALLASTS ARE REQUIRED IN ALL COBRA-HEAD LUMINAIRES.
- 8. ALL #10 AWG WIRES USED FOR MULTIPLE CIRCUIT ELECTROLIER REFERENCED IN STANDARD DRAWING NO. L-301-1 SHALL BE #10 AWG SOLID COPPER CONDUCTORS.
- 9. AT LEAST TWO (2) WORKING DAYS PRIOR TO STARTING ANY EXCAVATION, THE CONTRACTOR MUST OBTAIN AN INQUIRY I.D. NUMBER FROM UNDERGROUND SERVICE ALERT BY CALLING (800) 422-4133 OR BY DIALING 811.

SERIES CIRCUIT NOTES

- 1. WARNING: SAFETY CLEARANCE SHALL BE OBTAINED DAILY FROM THE SERVING COMPANY, AND "MEN AT WORK" SIGNS SHALL BE POSTED AT THE SERVICE POINT BEFORE ANY WORK IS DONE OR ANY CONNECTIONS MADE ON AN EXISTING CIRCUIT. SEE SECTIONS 16430 AND 2100 OF SPECIAL SPECIFICATIONS.
- 2. SERIES CIRCUIT WIRE SHALL BE NO. 6 AWG STRANDED COPPER CONDUCTOR, INSULATED WITH 0.110" APPROVED POLYETHYLENE COMPOUND RATED FOR 5,000 VOLT OPERATION.
- 3. TWO OR MORE TURNS OF SELF-ADHESIVE COLORED TAPE WITH A MINIMUM WIDTH OF 1/2" INCH SHALL BE APPLIED TO EACH CABLE IN ALL SERIES CIRCUITS WHERE WORK IS BEING DONE AND WHERE TWO OR MORE CIRCUITS EXIST IN A COMMON PULLBOX OR POST BASE. THE TAPE SHALL BE APPLIED ON THE CABLE BETWEEN THE SPLICES AND THE CONDUIT, USING ONE COLOR FOR EACH CIRCUIT. THE COLORS WHITE, GRAY, GREEN, AND ORANGE SHALL NOT BE USED.
- 4. CONTRACTOR SHALL GIVE THE BUREAU OF STREET LIGHTING YARD (PHONE 323-913-4743) TWO WORKING DAYS NOTICE BEFORE ANY WORK IS DONE ON AN EXISTING SERIES CIRCUIT.

CIRCUIT DIAGRAM LEGEND

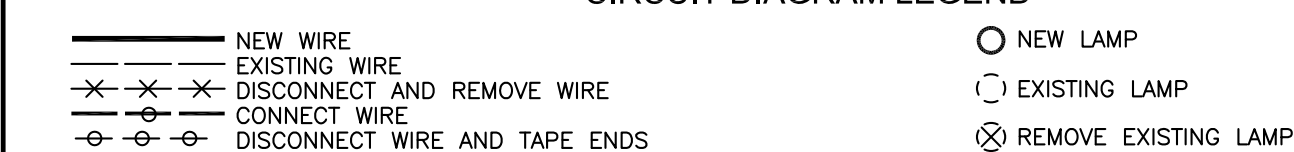

MULTIPLE CIRCUIT NOTES

- 1. WARNING: SAFETY CLEARANCE SHALL BE OBTAINED DAILY FROM THE SERVING COMPANY BEFORE DOING ANY WORK OR MAKING ANY CONNECTIONS ON AN EXISTING CIRCUIT. SEE SECTIONS 16430 AND 2100 OF SPECIAL SPECIFICATIONS.
- 2. MULTIPLE CIRCUIT WIRE SHALL BE NO. 6 AWG STRANDED COPPER CONDUCTOR, TYPE THWN/THHN INSULATION, UL APPROVED FOR 600 VOLT OPERATION UNLESS OTHERWISE SPECIFIED HEREON.
- 3. THREE WIRES (COLOR CODE: 1-RED, 1-BLACK, 1-WHITE) SHALL BE INSTALLED IN ALL MULTIPLE CIRCUIT CONDUIT UNLESS OTHERWISE PROVIDED FOR HEREON.
- 4. EVEN NUMBERED ELECTROLIER SHALL BE CONNECTED TO RED AND WHITE WIRES AND ODD NUMBERED ELECTROLIER SHALL BE CONNECTED TO BLACK AND WHITE WIRES.
- 5. ELECTROLIER SHALL BE WIRED PER TYPICAL MULTIPLE CIRCUIT ELECTROLIER WIRING DETAIL, BUREAU OF STREET LIGHTING STANDARD DRAWING NO. L-301-1, UNLESS OTHERWISE SPECIFIED.
- 6. MULTIPLE CIRCUITS IN CONDUITS CONTAINING MORE THAN THREE CONDUCTORS SHALL BE APPROPRIATELY IDENTIFIED BY LABELING CONDUCTORS "A", "B", ETC. WITH APPROVED SELF-LAMINATING LETTER TAPE WRAPPED AT LEAST TWICE AROUND THE CONDUCTOR IN EACH PULLBOX. (W.H. BRADY, SPECIAL SELF-LAMINATING WIRE MARKERS OR EQUIVALENT)

LEGEND

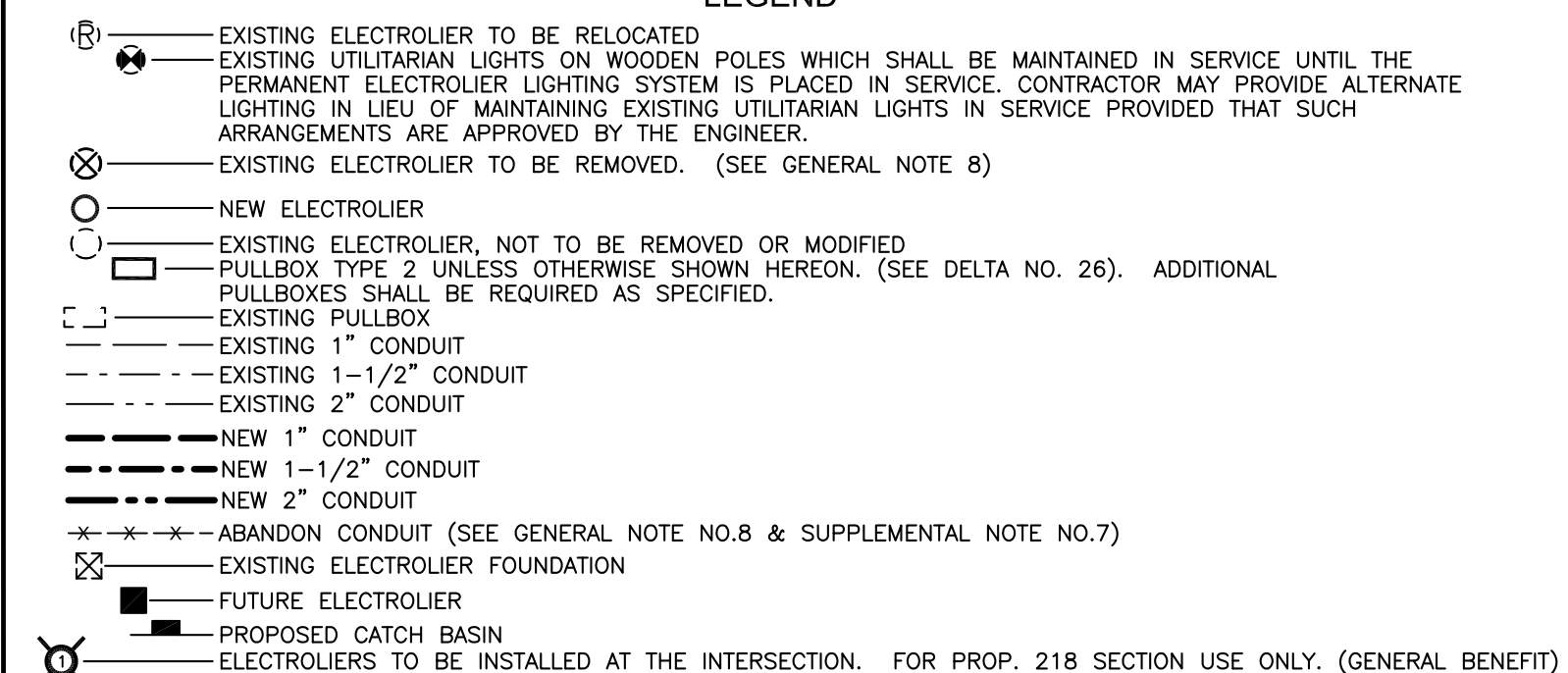

NOTICE TO CONTRACTORS
MATERIAL LIST

THE FOLLOWING IS A SUMMARY OF NEW ELECTROLIER, LUMINAIRES, LAMPS, BALLASTS, FOUNDATIONS, AND OTHER EQUIPMENT WHICH SHALL BE SUPPLIED AND INSTALLED BY THE CONTRACTOR. THIS IS NOT INTENDED TO BE A COMPLETE LIST OF ALL MATERIALS REQUIRED

Table with columns: SYMBOL, ITEM, QUANTITY, DESCRIPTION, STANDARD PLAN NO., REV. NO. Includes items like ELECTROLIER, LUMINAIRE, LAMP, BALLAST, and ELECTROLIER with quantities and descriptions.

* SET LUMINAIRE TO I.E.S., MEDIUM, CUTOFF, TYPE III LIGHTING DISTRIBUTION.

MATERIAL LIST NOTES

- 1. ALL COBRAHEAD TYPE LUMINAIRES SHALL BE INSTALLED WITHOUT STARTER AND ADHERE TO GENERAL NOTE 16. ALL HPS LAMPS WITHIN COBRAHEAD TYPE LUMINAIRES SHALL BE "EYE IGNITE" PER CORRESPONDING EYE LIGHTING INTERNATIONAL OF NORTH AMERICA CATALOG #'S AS FOLLOWS, OR BSL APPROVED EQUAL:
150W-59707, 200W-59914, 250W-60012, 310W-60050, 400W-60110
- 2. ALL COBRAHEAD LUMINAIRES REGARDLESS OF WATTAGE ON LOW VOLTAGE, MULTIPLE CIRCUITS SHALL BE EQUIPPED WITH A MONITORING NODE. THE UNIT SHOULD BE PICKED UP AT THE BUREAU'S PLAN COUNTER AT 1149 S. BROADWAY, SUITE #200, LOS ANGELES, CA 90015. THE UNITS WILL BE PROVIDED FOR A NON-REFUNDABLE FEE (APPROXIMATELY \$ 100.00 PER UNIT). THE CONTRACTOR SHALL GIVE SEVEN WORKING DAYS NOTICE (TELEPHONE 231 847-1498) PRIOR TO PICKING UP THE MONITORING UNITS. NODES SHALL BE INSTALLED INTO THE PHOTOELECTRIC CONTROL STANDARD SOCKET PER INSI/NEMA C-136.10 AND SHALL BE ORIENTED IN A NORTHERLY DIRECTION. A SEPARATE P.E. CELL IS NOT REQUIRED FOR LUMINAIRES EQUIPPED WITH A REMOTE MONITORING NODE.
- 3. INDICATES RELOCATE EXISTING WHILESHIRE SPECIAL ELECTROLIER PER STANDARD PLAN B-541 REV. 20. REMOVE AND DISPOSE OF EXISTING FOUNDATION, PULLBOX, LUMINAIRE, LAMP AND BALLAST. INSTALL NEW FOUNDATION, NEW TYPE 2 PULLBOX AND NEW EQUIPMENT PER MATERIAL LIST. (SEE GENERAL NOTE NO. 22 & DELTA NOTE NO. 25). INDICATE REMOVE AND DISPOSE OF EXISTING LUMINAIRE, LAMP AND BALLAST. INSTALL NEW EQUIPMENT PER MATERIAL LIST.

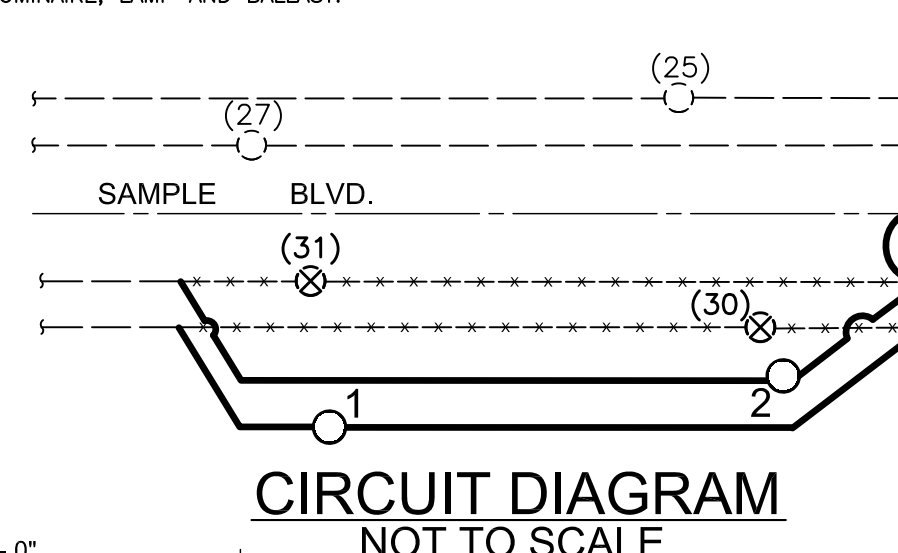

CIRCUIT DIAGRAM NOT TO SCALE

UNLESS OTHERWISE SPECIFIED HEREON
ALL NEW CONDUIT SHALL BE 1 1/2"
GALVANIZED WITH NO. 6 WIRES.

ALL CONSTRUCTION IS PROHIBITED ON MAJOR
AND SECONDARY STREET BETWEEN:
6:00 A.M. TO 9:00 A.M.
3:30 P.M. TO 7:00 P.M.

NOTICE TO CITY INSPECTOR/CONTRACTOR NO. 1

THIS PROJECT IS IMPACTED BY PROPOSITION 218
ELECTROLIER(S) SPECIFIED HEREON SHALL NOT BE INSTALLED UNTIL THE LEGAL REQUIREMENTS OF PROPOSITION 218 HAVE BEEN SATISFIED. THE CITY INSPECTOR SHALL CONTACT THE BUREAU OF STREET LIGHTING ENGINEERING AND TECHNICAL SERVICES DIVISION AT (213) 847 - 1431 FOR CONSTRUCTION CLEARANCE. UNDERGROUND FACILITIES MAY BE INSTALLED PRIOR TO PROPOSITION 218 CONSTRUCTION CLEARANCE.

NOTICE TO CITY INSPECTOR/CONTRACTOR NO. 2

THE LUMINAIRES SPECIFIED ON THIS PLAN ARE VALID FOR ONLY 6 MONTHS FROM FINAL PLAN APPROVAL. THE CONTRACTOR SHALL VALIDATE THE CATALOG NUMBER WITH THE BUREAU OF STREET LIGHTING PRIOR TO CONSTRUCTION.

PLAN OF ELECTROLIER LIGHTING SYSTEM

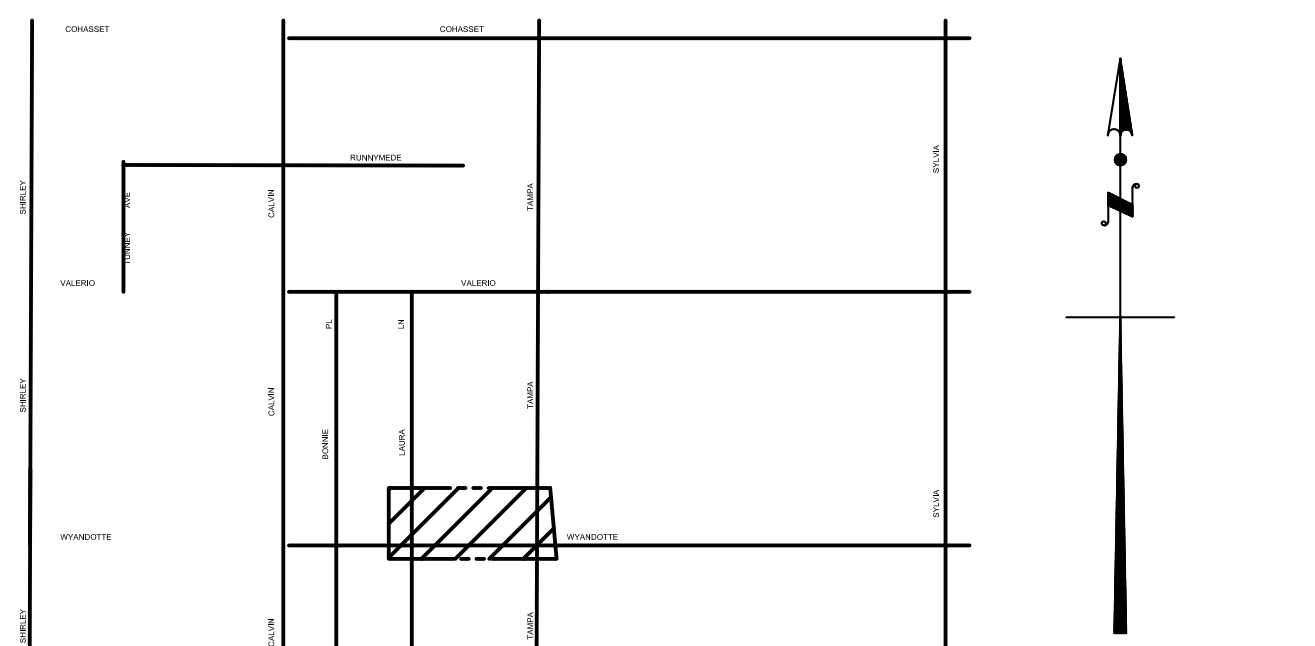
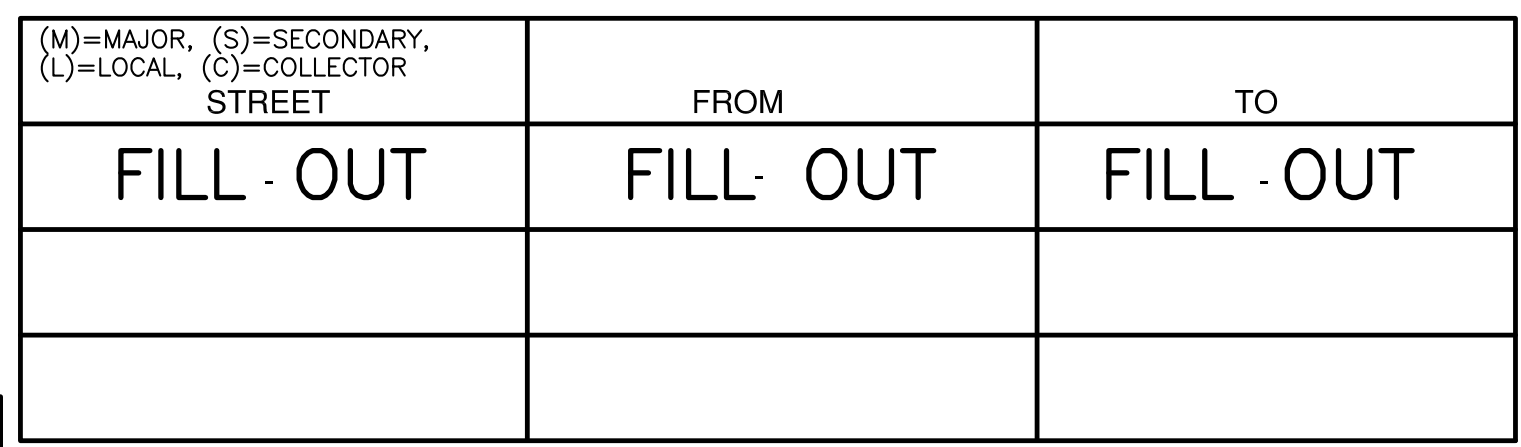

VICINITY MAP SCALE: 1" = 500'

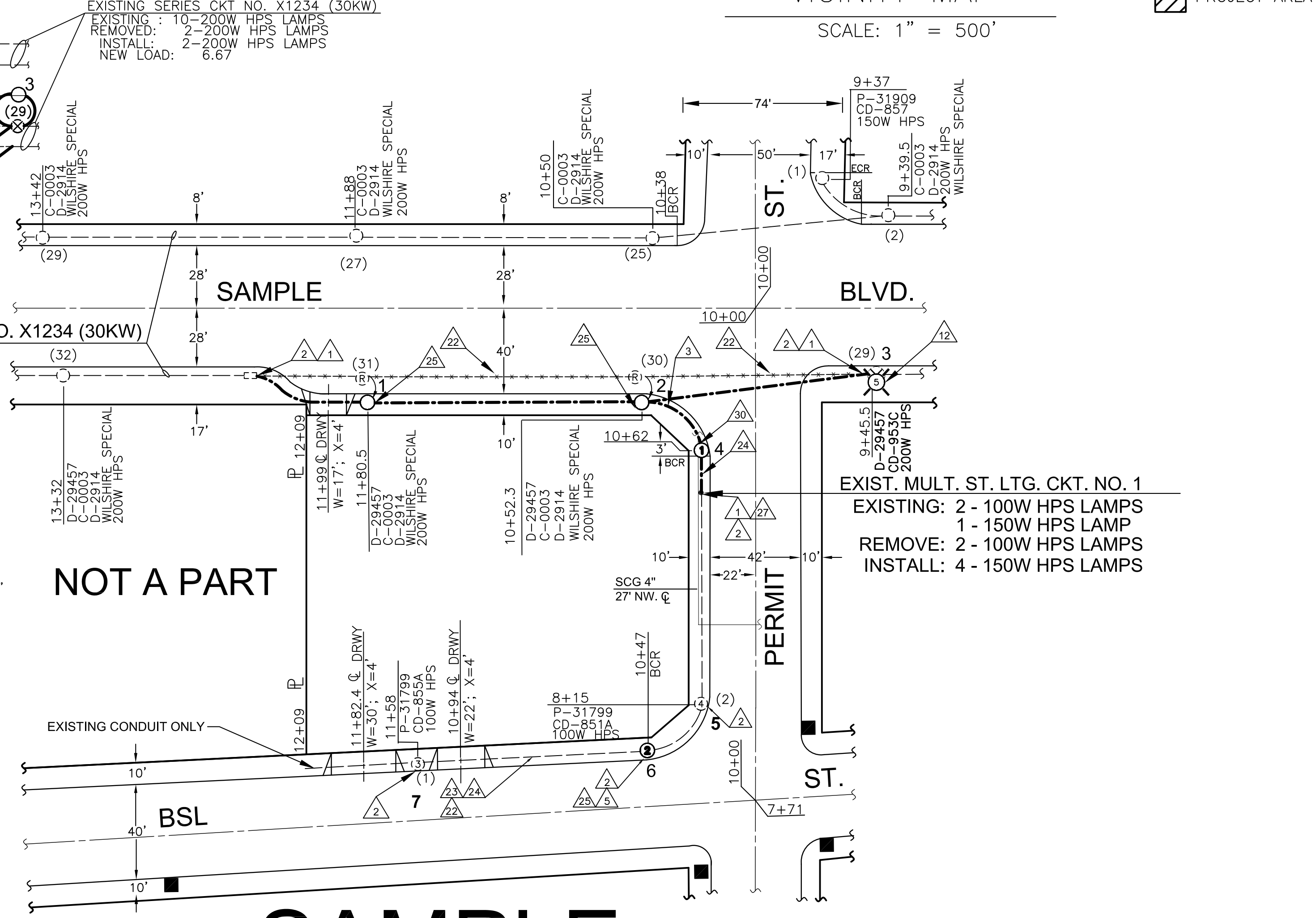

NOT A PART

SAMPLE

CASE (TRACT, PMLA, VAC, ZA,CPC,DIR, APC, GEN IMP, VOL IMP)
B-PERMIT TITLE

Approval form with sections for 'PLANS PREPARED BY', 'ENGINEER'S SEAL', and 'ACCEPTANCE' table with columns for Department/Bureau, Engineer, Date, and Acceptance.

BUREAU OF STREET LIGHTING
DEPARTMENT OF PUBLIC WORKS
CITY OF LOS ANGELES